

SEE PAGE 46
FOR SWITCHES

Series 11 Actuators

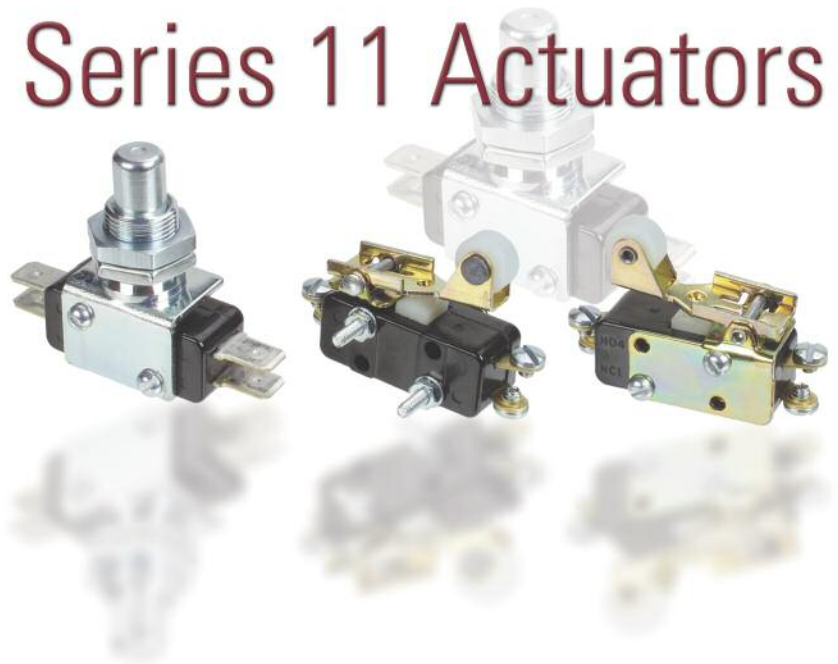

KEY FEATURES:

- Roller Lever
- Overtravel

MECHANICAL CHARACTERISTICS*:

Part Number	Oper. Force	Release Force	Pretravel	Overtravel	Movement Diff.	Operating Point
71-1040 Roller Lever	3.5 oz max	2 oz min	.093 max	.062 min	.030 ± .015	.671 ± .031
71-2010 Overtravel Plunger	8 ± .3 oz	4 oz min	.050 max	.215 min	.020 ± .005	.828 ± .015

*Mechanical characteristics when used with Basic Switch 11-104.

71-1040

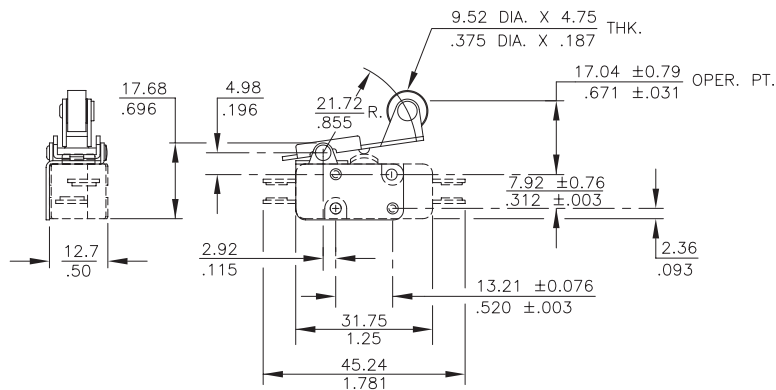

71-2010

