

## MINIATURE 10 AMP DOUBLE-BREAK SNAP ACTION SWITCHES

This series is intended for use in industries where rugged construction is required such as heavy industrial and military. Long life is insured by ITW's unique Butterfly action. They provide high heat resistance and reduced arcing in DC applications. The 11 Series offers a variety of terminal styles and actuators.

### APPLICATIONS:

- Welding Guns
- Lift Truck Controls
- Valve Actuators
- Foot Switches
- Bus and Railcar Door Controls
- Automatic Tape Dispensers

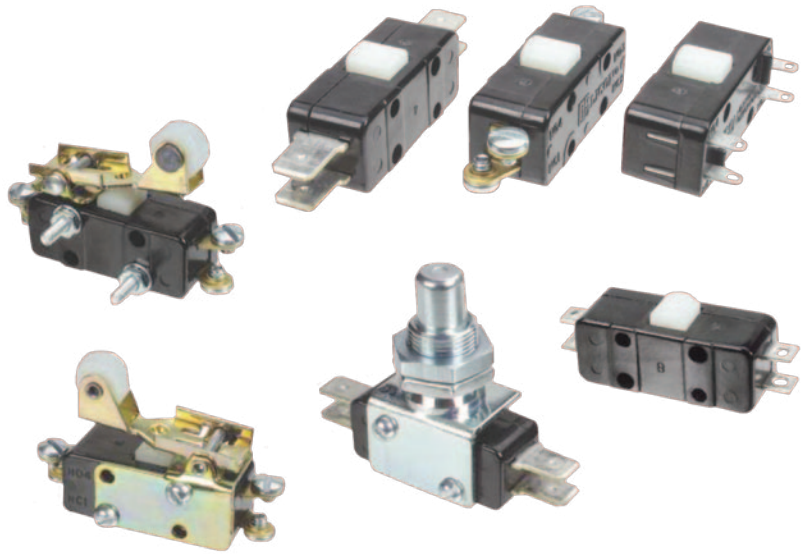

### KEY FEATURES: SWITCH

- Gold or silver contacts
- Variety of terminals configurations and styles available
- UL recognized and CSA certified
- Reset style switch available
- Roller lever and overtravel plunger actuator are available

### KEY FEATURES: ACTUATOR

- Roller Lever
- Overtravel

### ORDERING INFORMATION:

Part Number	Terminals
11-104	End Solder
11-204	#4 Screw
11-304	Side Solder

Part Number	Terminals
11-314	Reset Side Solder
11-504	Quick Disconnect .250
11-504001*	Quick Disconnect .250

\* - Enhanced Gold Contacts

### ACTUATORS

Part Number		Oper. Force	Release Force	Pretravel	Overtravel	Movement Diff.	Operating Point
<b>71-1040</b>	Roller Lever	5.5 oz	1.7 oz min	.093 max	.062 min	.045 ± .015	.671 ± .031
<b>71-2010</b>	Over Travel	8 ± 3 oz	4 oz min	.050 max	.215 min	.020 ± .005	.828±.015

### 71-1040

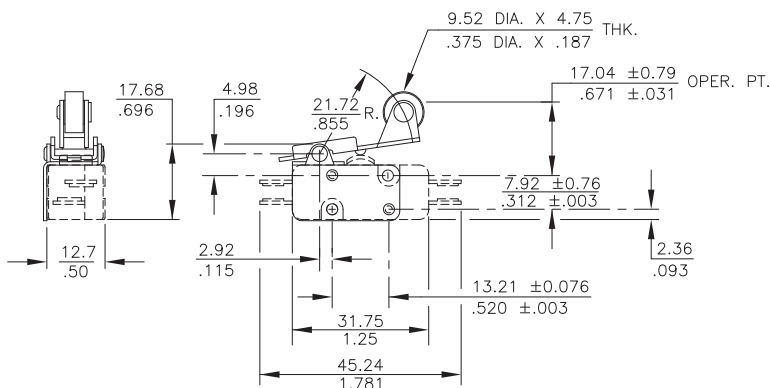

### 71-2010

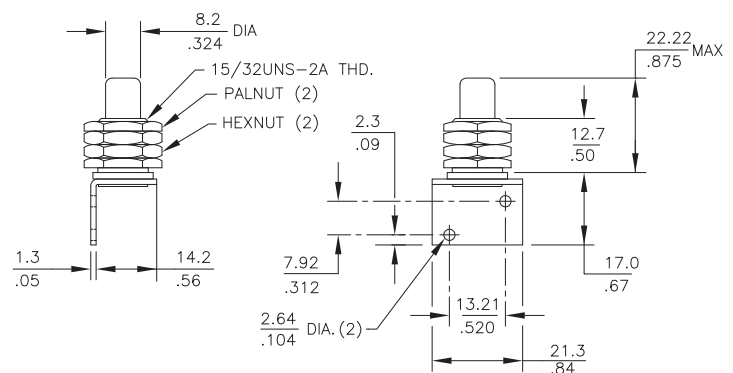

**END SOLDER**

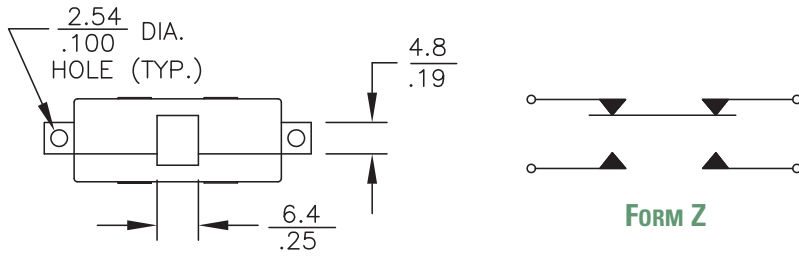

**#4 SCREW**

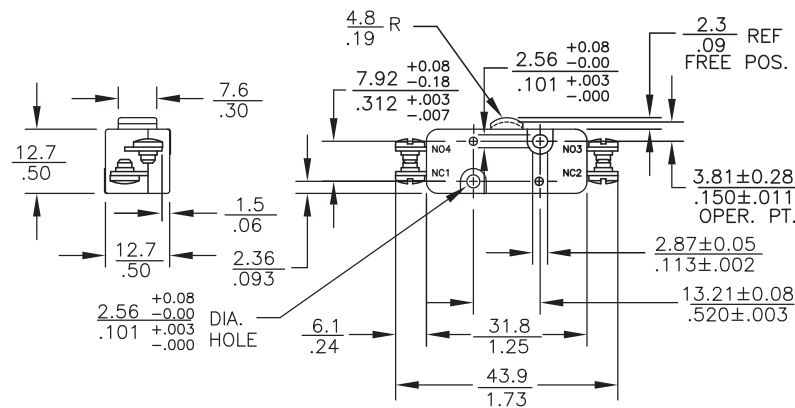
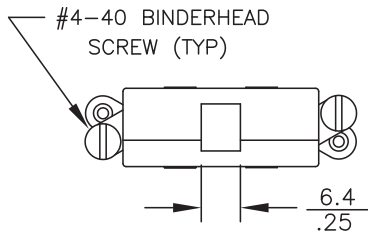

**SIDE SOLDER**

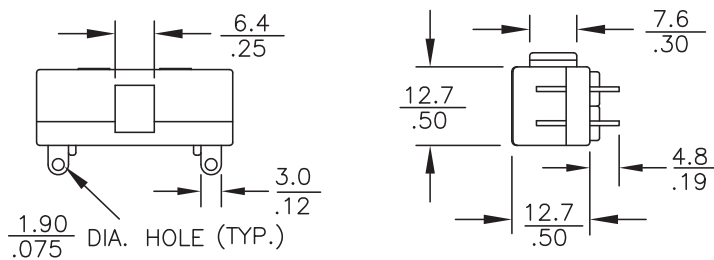

**QUICK DISCONNECT**

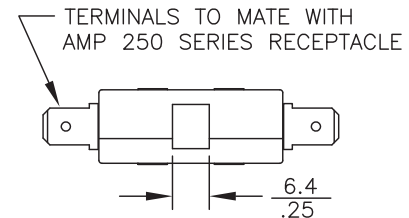
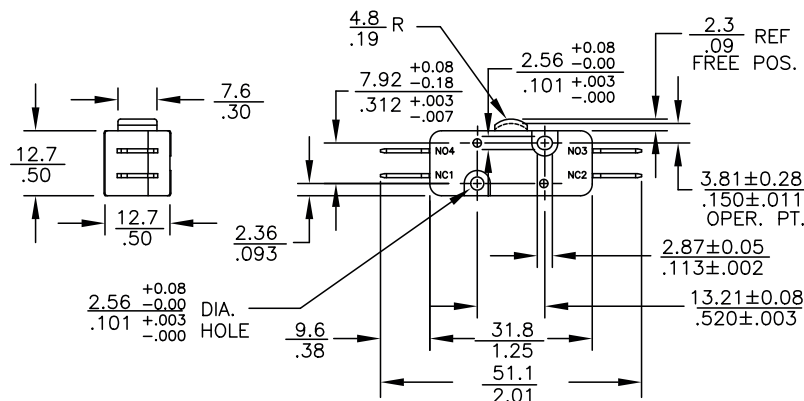

**MECHANICAL / ELECTRICAL / ENVIRONMENTAL CHARACTERISTICS:**

**Circuit:**  
SPDT-DB (Form Z)

**Pretravel:**  
0.050 inches max

**Overtravel:**  
0.015 inches min

**Operating Force:**  
8 oz + 3 oz

**Release Force:**  
4 oz min

**Movement Differential:**  
0.020 ± 0.007 inches

**Operating Point:**  
0.150 ± 0.011 inches  
(from mounting hold centers)

**Electrical Ratings (Typical):**

Circuitry	125/250 VAC	28 VDC
SPST-DB NC (Form Y)	10 amp (75-80% PF)	10 amp Ind
or NO (Form X)	1/2 HP	15 amp Res
SPDT-DB (Form Z)	125 VAC	7 amp Ind 10 amp Res
SPDT-SB (Form C)	3/4 HP 250 VAC	4 amp Ind 6 amp Res